



Features

- 70A switching capability.
- Contact Arrangement 1 form A
- A variety of working voltage
- Comply with ROHS、ELV directive

Typical Applications

Engine starting

CHARACTERISTICS

Contact Arrangement	1A	Ambient Temperature	- 40°C ~ + 75°C
Contact Material	AgSnO ₂	Relative Humidity	85%(40°C)
Contact Rating (Res.)	NO 70A , 28VDC	Insulation Resistance	100MΩ min(500VDC)
Max. Continuous Current	70A	Vibration Resistance	14Hz~200Hz 1.27mm
Max. Switching Current	150A	Shock Resistance	147m/s ² 11ms
Contact Resistance	≤200mΩ	Dielectric Strength	1 K Vac,1min
Electrical Life	5×10 ⁴ ops	Termination	Plug-in
Mechanical Life	1×10 ⁷ ops	Construction	Dust covered
Terminals Strength	9-12N*m		

ORDERING INFORMATION

Type	QD70/	024	1	S	R
Coil Voltage	012:12vdc 024:24vdc				
Shell form:	1 dust cover 2mounting plate				
Package Type:	Nil: No plastic S: plastic				
Parallel element:	R:Parallel resistance D: Parallel diode				

COIL DATA

NO	Nominal Voltage (V. d. c)	Pick-up Voltage (V. d. c)	Pick-up Voltage (V. d. c)	Coil Resistance (Ω)	Coil Resistance (W)	Max. Allowable Overdrive (V. d. c)
12	12	7.5	0.5	45	3.2	28
24	24	15	1	180	3.2	14

LOAD DATA

2/2

Nominal Voltage	Nominal Voltage	Carry current (A)	Break-make ratio		Contact Material	Testing Ambient temp.
			ON (S)	OFF (S)		
24VDC	Res. 28VDC on/off	NO	1	5	AgSn02In03	23°C
		70				

OUTLINE DIMENSIONS AND WIRING DIAGRAM

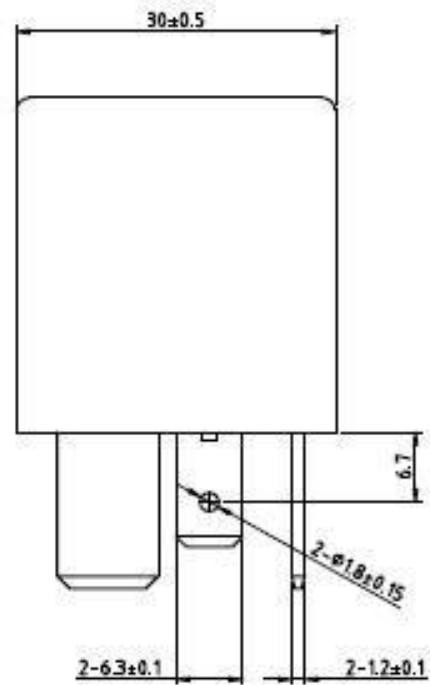
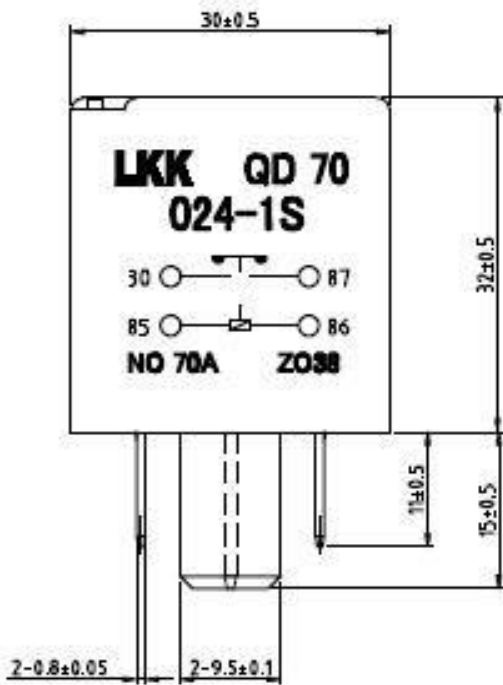

Bottom view

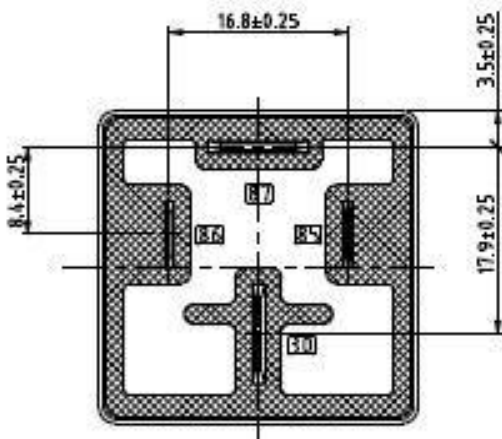

Wiring Diagram

