

LKK MTB-012-1H Timer Relays



Features

- Resistance load: 13.5V/30A
- Delaying time: 12 ± 1.2 Min
- Operate voltage: $\leq 9.0V$
- Off-delay Operation; Dustproof structure

Typical Applications

Automotive window heating timers.

CHARACTERISTICS

Ambient Temperature	-30°C to +85°C
Norminal voltage	12VDC
Delaying Time	12 ± 1.5 Min
Contact Rating	Resistance load: 13.5V/30A
Operate Voltage	$\leq 9.0V$
Release voltage	$\geq 1.2V$
Load Voltage Range	9 to 16VDC

Terminal Type	QC
Weight	34g
Oscillation	10 to 55 Hz $49m/s^2$ (5g)
Impulsion	$200m/s^2$ (20g)
Electrical Life	1×10^5 ops
Outline L×W×H	30.0×30.0×30.0 mm

Outline Dimensions

Wiring Diagram

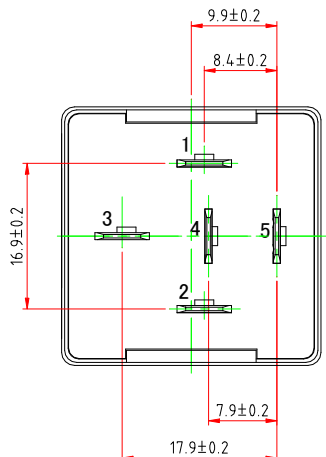
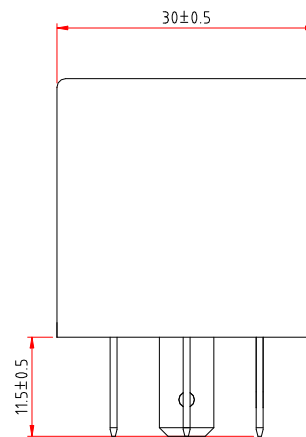
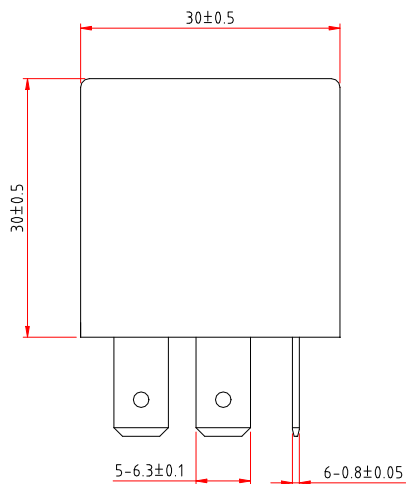

Wiring Diagram

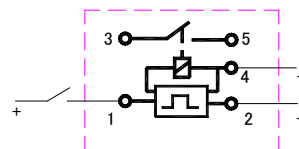

LKK Time Relays



Features

- Resistance load: 13.5V/30A
- Delaying time: $2.0 \pm 0.5S$
- Operate voltage: $\leq 9.0V$
- On-delay Operation; Dustproof structure

Typical Applications

Delaying control of dynamo, Oil pump & radiator.

CHARACTERISTICS

Ambient Temperature	-30°C to +85°C
Normal voltage	12VDC
Delaying Time	$2 \pm 0.5s$
Contact Rating	Resistance load: 13.5V/30A
Operate Voltage	$\leq 9.0V$
Normal voltage	$\geq 1.2V$
Load Voltage Range	9 to 15VDC

Terminal Type	QC
Weight	34g
Oscillation	10 to 55 Hz $49m/s^2$ (5g)
Impulsion	$200m/s^2$ (20g)
Electrical Life	1×10^5 ops
Outline L×W×H	30.0×30.0×30.0 mm

Wiring Diagram, Outline Dimensions

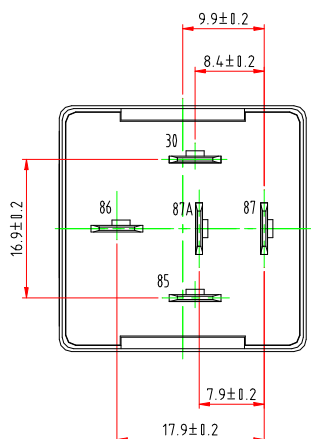
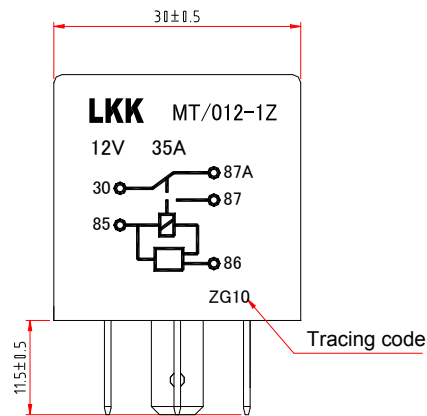
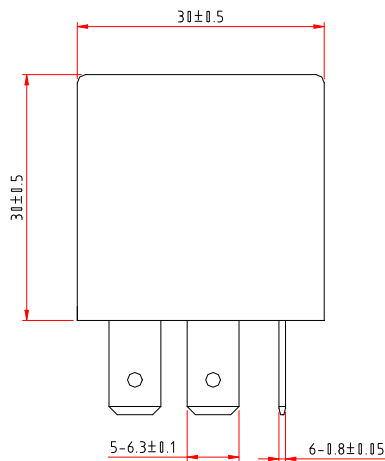

Wiring Diagram

